

Community Amenities

- ◆ Gated Access Community
- ◆ 20,000 SF Modern Clubhouse
- ◆ Late Night Concierge Services
- ◆ 24 Hr Fitness Center with PRECOR Equipment
- ◆ 78 Seat Movie Theater
- ◆ Conference Room
- ◆ Fitness on Demand
- ◆ Elite Poker and Wine Room
- ◆ Library/Study Room
- ◆ Cyber Lounge featuring Starbucks Java Bar
- ◆ Tanning Rooms
- ◆ Corporate Executive Suites
- ◆ Covered Parking & Garages
- ◆ Resort Style Pool with Cabanas
- ◆ Covered Outdoor Kitchen
- ◆ Sports Lounge
- ◆ Bar-B-Que Grills w/Picnic Area
- ◆ High Speed Internet Access at the Pool and Clubhouse
- ◆ Three Outdoor Firepits

Apartment Amenities

- ◆ Free Water, Sewer, & Trash
- ◆ Free Monitored Intrusion Alarms
- ◆ Free AT&T Uverse Internet
- ◆ Free AT&T Uverse TV
- ◆ Kitchen Pantry
- ◆ Stainless Steel Appliances
- ◆ Kitchen Island w/built in Wine Rack
- ◆ Granite Countertops
- ◆ Custom Cabinetry
- ◆ Ceramic Tiled Bathrooms
- ◆ Soak Tubs
- ◆ Glass Showers Featuring Rain Showerheads
- ◆ Recessed Lighting & Ceilings
- ◆ Ceiling Fans
- ◆ Private Balconies

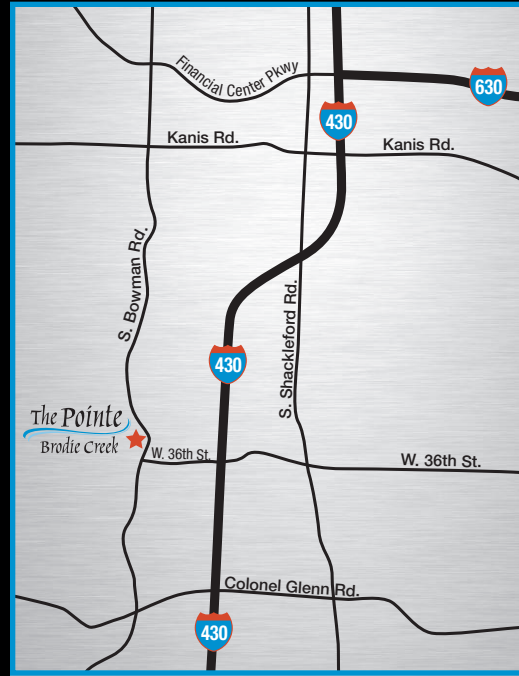

3400 S. Bowman Rd
Little Rock, AR 72211

501.221.3377
Fax 866.860.2537

www.pointebrodiecreek.com



 **RICHARDSON**
PROPERTIES, LLC

The Pointe Brodie Creek



The Pointe

Brodie Creek

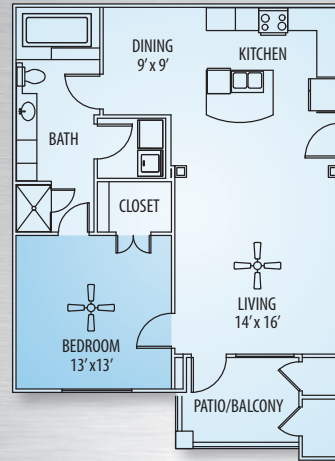

Richland

1 Bedroom
1 Bath
900 sq. ft.*

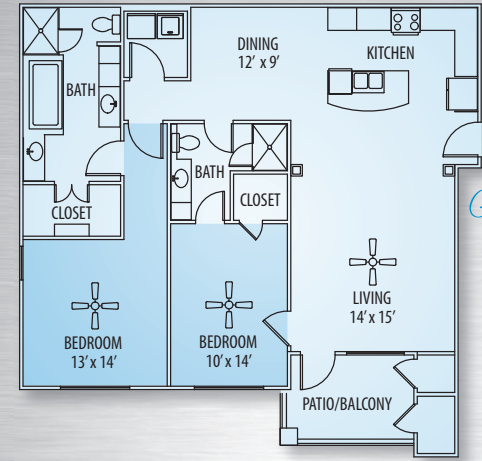

Kingston

2 Bedroom
2 Bath
1250 sq. ft.*

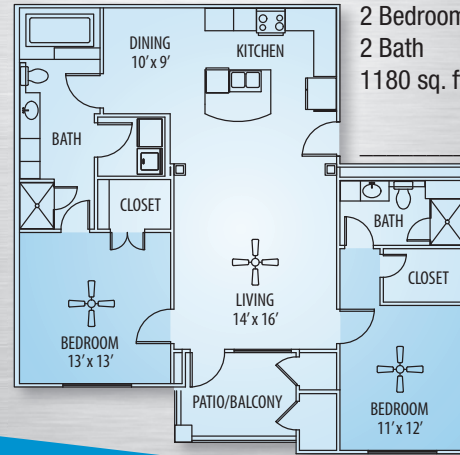

Harmony

2 Bedroom
2 Bath
1180 sq. ft.*

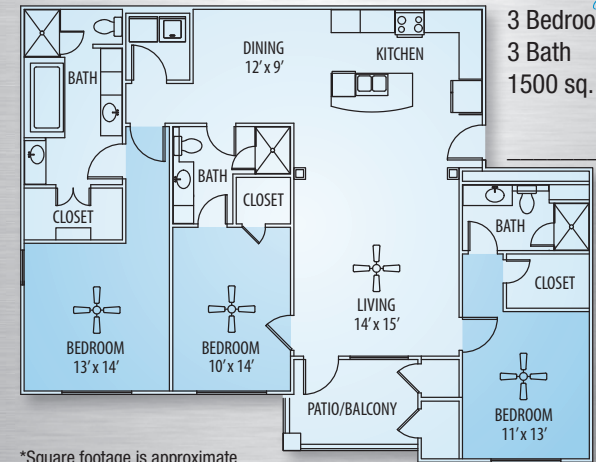

Bentley

3 Bedroom
3 Bath
1500 sq. ft.*

*Square footage is approximate.

